

19/11/2023
 JEN/MD-3
 19/1/2023
 AE-I/MD-3

450.0 M. T. R/W ROAD NO. 43

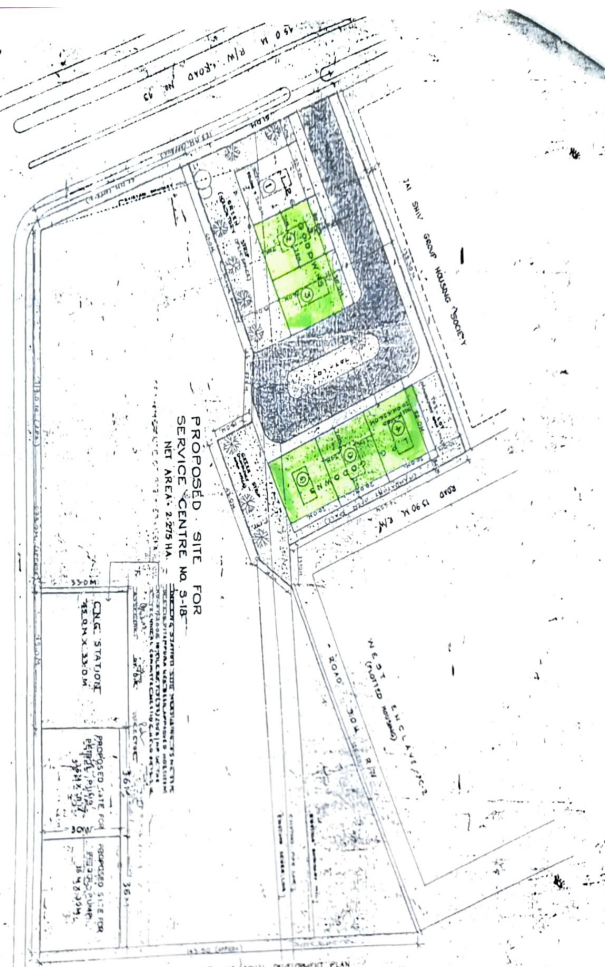

PROPOSED N.R.P. 42 ZONAL DEVELOPMENT PLAN OF ZONE - H

NOTE: - All existing structures, trees, and other features shown on this plan are as they exist on the date of preparation of this plan. Any changes to be made shall be approved by the competent authority.

KEY-PLAN



AREA TOTAL AREA NET AREA COVERED AREA UNCOVERED AREA ROAD AREA WATER BODY AREA OTHER AREA	LAYOUT ENCLOSURE PITCHING PAVEMENT	PROPOSED SERVICE CENTRE NO. 3-1B NET AREA: 2879 HA CHIEF STATION PROPOSED SITE FOR	ROAD 19.50 M. CM. ROAD 30.0 M. CM. ROAD 450.0 M. T. R/W ROAD NO. 43
--	---	---	---