

114110/2021/O/o SR. ARCHITECT(HUPW)-DWARKA ZONE

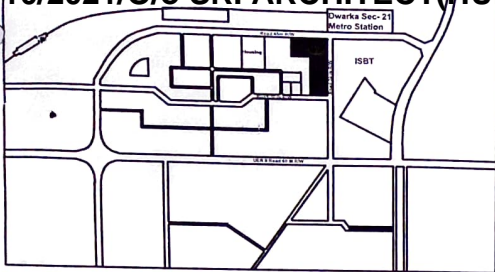

Key Plan

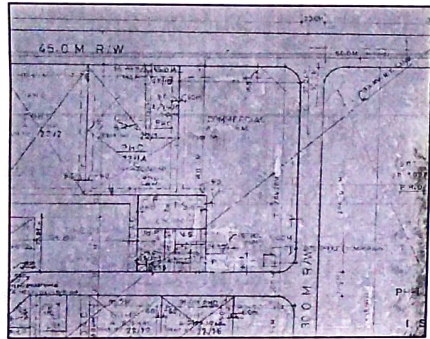

Part Layout plan of sector 22, Dwarka

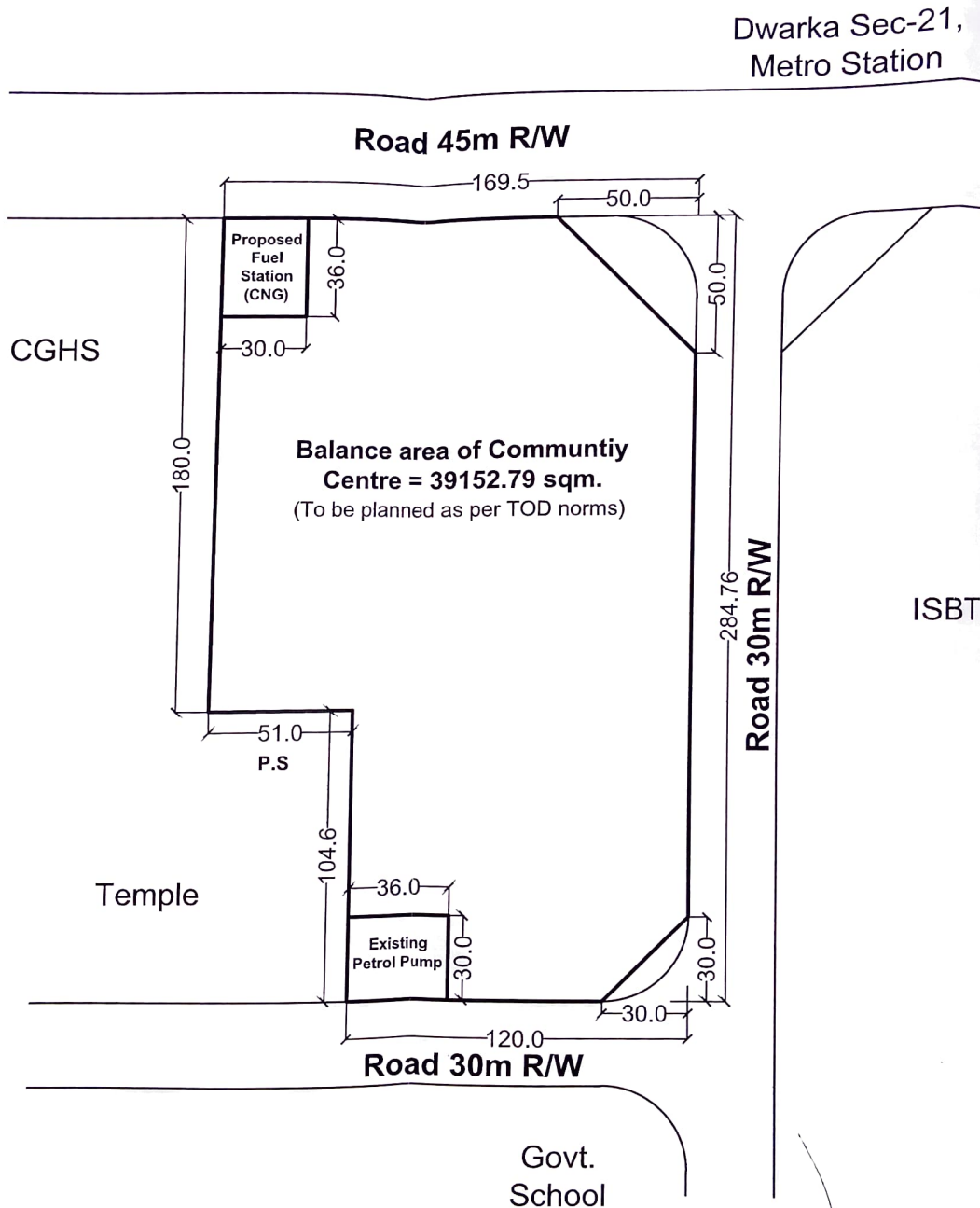

Dwarka Sec-21,
Metro Station

ISBT

Govt.
School

D D A

- Area of Community Centre = 4.13 Hac. (41312.79 sqm.)
- Area under existing Petrol Pump = 1080 sqm.
- Area under Proposed Fuel Station(CNG) = 30M X 36M = 1080 sqm.
- Balance Site area of Community Centre = 39152.79 sqm.

Note: The Proposal has been approved in 388th SCM dated 04.12.2020 vide item no. 123:2020

DELHI DEVELOPMENT AUTHORITY
CERTIFIED
Approved in ...388th... Screening
Committee Meeting Dt. 04.12.2020
vide Item no. 123:2020
Sign... *[Signature]* / 2020
Name... DEEPANKAR SINGH
Designation ... S.A. (Arch.)

DELHI DEVELOPMENT AUTHORITY
HUPW-CO-ORDINATION UNIT
VERIFIED
This proposal was considered in the
388th Screening Committee
Meeting held on... 04.12.2020
Vide item No. 123:2020
[Signature] 11.01.2021
Dy. Director (Arch.) Co-ordn.

	Community Centre at Sector 22, Dwarka	
	सेक्टर 22 द्वारका में सामुदायिक केंद्र	
SCALE	SCH. NO.	
DATE: PERM. 20	DWG. NO.	
DRAWING TITLE LAYOUT PLAN लेआउट प्लान		
 ARCH. ASSTT. / आर्किटेक्चर सहायक	 ASSTT. DIRECTOR (ARCHT.) / सहायक निदेशक	
 DY. DIRECTOR (ARCHT.) / डी. निदेशक	 SENIOR ARCHITECT / वरिष्ठ आर्किटेक्चर	
दिल्ली विकास प्राधिकरण वरिष्ठ वास्तुकार - द्वारका / एचयूपीओवन्यू पहली मंजुरि, दि. 11.01.2021 दि. वा. परा. दफ्तर, मंगला पुरी, द्वारका, नई दिल्ली-110045		

RISHI RAJ

EAST ZONE

S. NO.	ST. NO.	DESCRIPTION	MUTATED AREA DETAILS		CHARTER AFTER MUTATION		CNG STATION SITE		TYPE	SCHEDULE	
			NO.	AREA (SQ. FT.)	NO.	AREA (SQ. FT.)	NO.	AREA (SQ. FT.)			NO.
1	01A	CONSTRUCTION	2483.00	2483.00	2483.00	2483.00	2483.00	2483.00	N/A	247	AST / MFD
2	01B	CONSTRUCTION	2483.00	2483.00	2483.00	2483.00	2483.00	2483.00	N/A	247	AST / MFD
3	02A	MAINT.	14,411.00	7,205.50	14,411.00	7,205.50	14,411.00	7,205.50	N/A	885	1,451 / 207
4	02B	MAINT./PSP	13,542.00	6,771.00	13,542.00	6,771.00	13,542.00	6,771.00	N/A	885	1,306 / 207
5	03	M/FPT	1,500.00	1,482.20	1,500.00	1,482.20	1,500.00	1,482.20	N/A	885	82 / 33
6	04	CONSTRUCTION	1085	316	1085	316	1085	316	N/A	262/38	20 / 207
7	05A	CONSTRUCTION	431.76	146.76	431.76	146.76	431.76	146.76	N/A	236/8	17 / 207
8	06	CONSTRUCTION	4316.00	1387.60	4316.00	1387.60	4316.00	1387.60	N/A	11	113 / 207
9	02A	MAINT.	6,008.84	3,004.42	6,008.84	3,004.42	6,008.84	3,004.42	N/A	885	178 / 207
10	07	CONSTRUCTION	3888	3111	3888	3111	3888	3111	N/A	885	208
11	08A	MAINT.	4,905.55	2,452.78	4,905.55	2,452.78	4,905.55	2,452.78	N/A	885	94 / 207
12	11	CONSTRUCTION	1323	353	1323	353	1323	353	N/A	262/38	15
13	12A	CONSTRUCTION	1332	332	1332	332	1332	332	N/A	262/38	15
14	13A	CONSTRUCTION	1488	472	1488	472	1488	472	N/A	262/38	15
15	13B	CONSTRUCTION	1488	472	1488	472	1488	472	N/A	262/38	15
16	14A	CONSTRUCTION	1488	472	1488	472	1488	472	N/A	262/38	15
17	15	Proposed	1000	238	1000	238	1000	238	N/A	8	-

SERVICES TO BE PROVIDED BY THE CLIENT

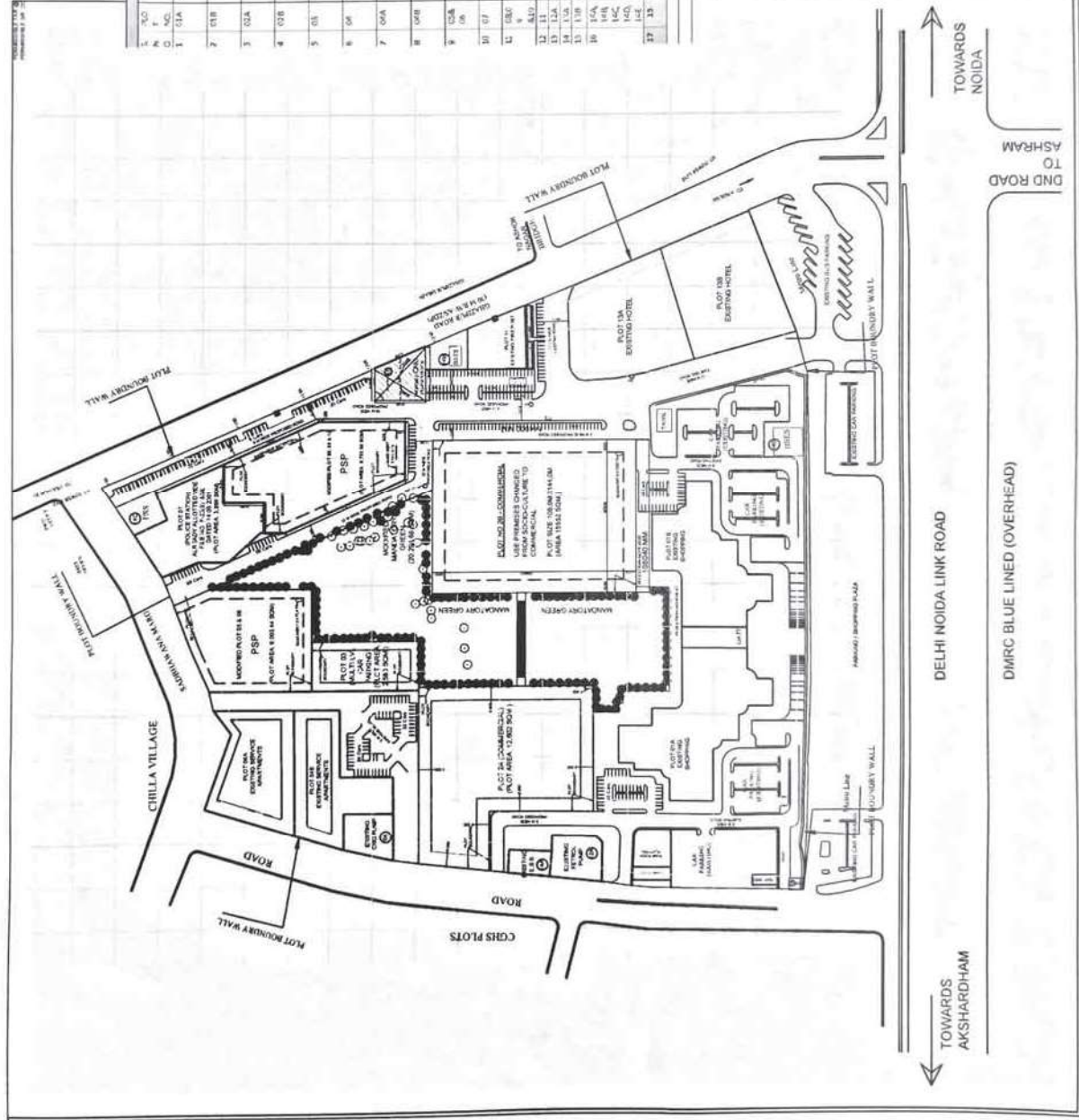

Project Title -
PROPOSED CNG STATION IN DC MAYUR VIHAR

Sheet Title -
MAYUR VIHAR DC

SCALE
DATE: JULY 2022
ARCH. ASSTT. (Handwritten signature)

SCH. NO.
DATE: JULY 2022
ASSTT. DR. (ARCH) (Handwritten signature)

SCH. NO.
DATE: JULY 2022
DR. (ARCH) (Handwritten signature)

SOM 01
DATE: JULY 2022
DR. (ARCH) (Handwritten signature)

ADD. CH. ARCH.
DR. (ARCH) (Handwritten signature)

CHIEF ARCHITECT
OFFICE OF SR. ARCHITECT -EZ
8TH FLOOR-HOUSING & URBAN PROJECTS WING
VIKAS MINAR, NEW DELHI-110002

वि.सि.क.

EAST ZONE

AREA CHART D.C. NORMS FOR CNG FILLING STATION PLOT NO. 15

AREA OF PLOT	1080 Sqm.
LAND USE PREMISES	30M X 36M (Trapezium shape Refer drawing)
LAND USE PREVIOUS	CNG FILLING STATION
GR. COVERAGE	200SQM (@20%)
TOTAL FAR	432 SQM (@40%)
HEIGHT	NR / AS PER AAI
BASEMENT	As/ requirement of parking as/ MPD-2021
PARKING	3 ECS/ 100 SQM OF TOTAL FAR
OTHER CONTROL	As/ MPD-2021 & UBBL 2016.

Project Title -

PROPOSED CNG STATION IN DC MAYUR VIHAR

Sheet Title:

MAYUR VIHAR DC

SCALE

DATE: JULY 2022

ASSTT.DR(ARCH)

ASSTT.DR(ARCH)

ADD. CH. ARCH.

CHIEF ARCHITECT

OFFICE OF SR. ARCHITECT -EZ

8TH FLOOR, HOUSING & URBAN PROJECTS WING

VIKAS MINAR, NEW DELHI-110002

SR. ARCHITECT

BY: DR (ARCH)

SCH.NO

ORG.NO

SCH-02

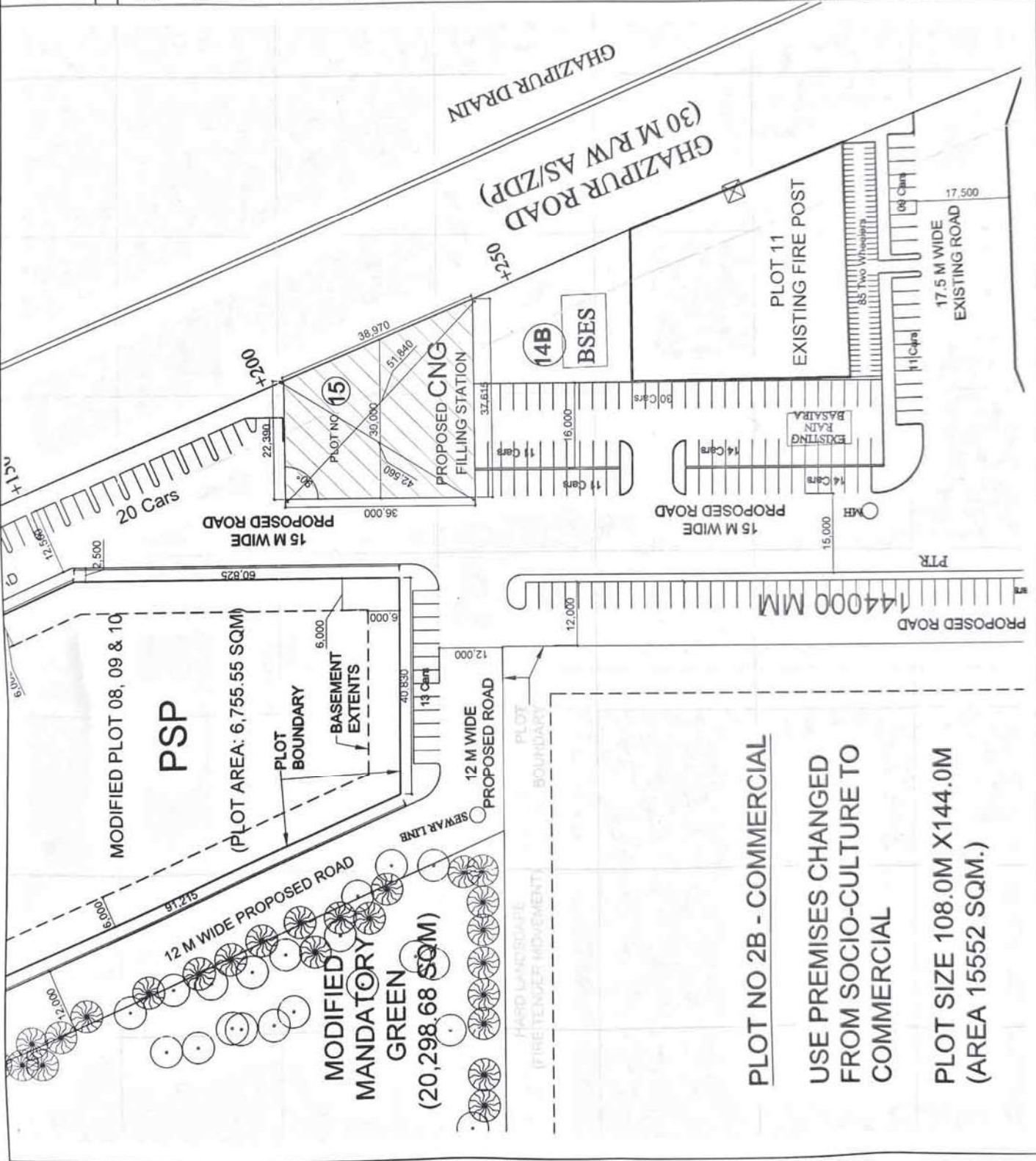

PLOT NO 2B - COMMERCIAL

USE PREMISES CHANGED FROM SOCIO-CULTURE TO COMMERCIAL

PLOT SIZE 108.0M X 144.0M (AREA 15552 SQM.)